

External, Self-Locking Friction, Metric

The DSF ring resembles a regular DSH ring except that it is designed to function on a shaft without a groove. The design of the ring causes it to exert significant gripping power uniformly on the shaft (except where the gap occurs.)

DSF Shaft Rings

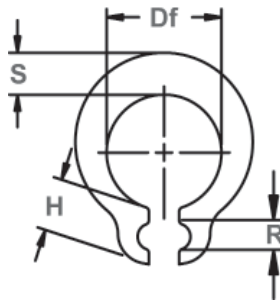

Free Diameter & Ring Measurements

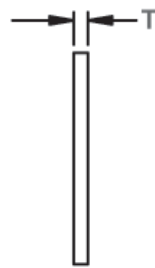

Shaft Diameter

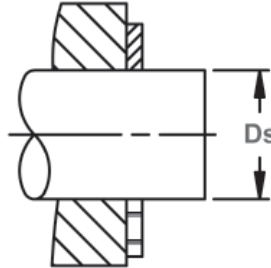

Clearance Diameter Installed on Shaft

RING NO.	SHAFT DIA. (mm)		RING SIZE & WEIGHT							SUPPLEMENTARY DATA		
			FREE DIAMETER		THICKNESS	LUG HEIGHT	MAX. SECTION	NOTCH	WEIGHT	CLEARANCE Released Over Shaft	THRUST LOAD	RPM Limits
	Ds	Tol.	Df	Tol.	T	H Max.	S Ref.	R Min.	kg/1000	L2	Pr N	
DSF-1.5	1.5		1.40		0.4	1.7	0.7	0.9	0.013	5.1	40	350000
DSF-2	2		1.90	±0.02	0.6	1.9	1.0	0.9	0.036	6.0	50	260000
DSF-2.2	2.2	+0.00	2.05	±0.025	0.6	1.9	1.1	0.9	0.038	6.2	50	270000
DSF-2.5	2.5	-0.04	2.35	±0.030	0.6	1.9	1.2	0.9	0.045	6.5	60	220000
DSF-2.8	2.8		2.65	±0.035	0.6	2.0	1.3	0.9	0.057	7.0	70	190000
DSF-3	3		2.85	±0.04	0.6	2.1	1.4	0.9	0.065	7.4	75	170000
DSF-3.5	3.5		3.30	±0.05	0.6	2.3	1.6	0.9	0.081	8.3	90	150000
DSF-4	4		3.80		0.8	2.7	1.8	1.2	0.154	9.6	100	125000
DSF-4.5	4.5	+0.00	4.25	±0.06	0.8	2.9	2.0	1.3	0.173	10.5	120	120000
DSF-5	5	-0.05	4.75		0.8	2.9	2.2	1.3	0.200	11.0	130	100000
DSF-5.5	5.5		5.20	±0.075	0.8	3.0	2.2	1.3	0.216	11.7	150	90000
DSF-6	6		5.70		1.00	3.2	2.4	1.4	0.402	12.6	170	81000
DSF-7	7		6.70		1.00	3.4	2.7	1.4	0.428	14.0	180	63000
DSF-8	8	+0.00	7.70	±0.09	1.00	3.5	3.0	1.4	0.524	15.2	200	52000
DSF-9	9	-0.06	8.65		1.20	4.7	3.3	2.0	0.808	18.6	230	46000
DSF-10	10		9.65		1.20	4.7	3.5	2.0	0.944	19.6	250	39000
DSF-10.5	10.5		10.20		1.20	4.0	3.8	1.5	1.100	18.7	260	34000
DSF-11	11		10.60		1.20	4.8	4.2	2.0	1.208	20.8	280	37000
DSF-12	12		11.60		1.20	4.8	4.6	2.0	1.454	21.8	300	33000
DSF-13	13		12.55		1.20	5.3	5.0	2.0	1.750	23.8	320	31000
DSF-13.8	13.8	+0.00	13.30	±0.11	1.50	5.1	5.4	2.2	2.492	24.8	350	30000
DSF-14	14	-0.07	13.50		1.50	5.1	5.4	2.2	2.456	25.0	350	29000
DSF-15	15		14.50		1.50	5.1	5.6	2.2	2.716	26.4	400	26000
DSF-16	16		15.40		1.50	5.6	5.8	2.5	2.940	27.8	500	26000
DSF-17	17		16.35		1.75	6.0	6.2	2.5	4.010	29.5	600	24000
DSF-18	18		17.30		1.75	6.1	6.6	2.5	4.460	31.4	700	23000
DSF-20	20		19.30		1.75	6.1	7.1	2.5	5.270	34.4	700	20000
DSF-22	22	+0.00	21.20	±0.13	1.75	6.6	7.4	2.5	6.060	37.0	750	18000
DSF-24	24	-0.08	23.15		1.75	6.6	7.8	2.5	7.000	39.8	750	16000
DSF-25	25		24.15		1.75	6.6	8.2	2.5	7.450	41.6	750	15000
DSF-30	30		29.00		1.75	9.0	9.0	2.5	10.000	48.2	750	12000

ALL DIMENSIONS IN MILLIMETERS.

HARDNESS RANGES: STAINLESS STEEL RINGS (DIN 1.4122 X39CrMo17)

RING TYPE	SIZE RANGE	HARDNESS			
		HV	HRC	15N	30N
DSF	ALL	470-580	47-54	84-87.5	66-72

HARDNESS RANGES: CARBON STEEL RINGS (SAE 1060-1090)

RING TYPE	SIZE RANGE	HARDNESS		
		VICKERS	ROCKWELL	
			HRC	LOWER SCALE**
DSF	1.5	485-560	48-53	84.5-87 HR15N**
	2-8	485-560	48-53	66.5-71 HR30N
	9-30	485-560	48-53	-

*WHERE APPLICABLE

**HARDNESS CAN NOT BE CHECKED WITH ANY DEGREE OF ACCURACY DIRECTLY ON THESE RINGS.

